

RoHS

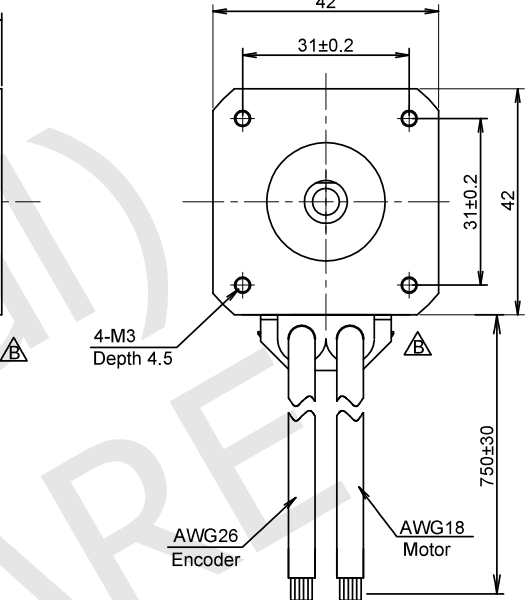

CCW FROM OUTPUT SHAFT

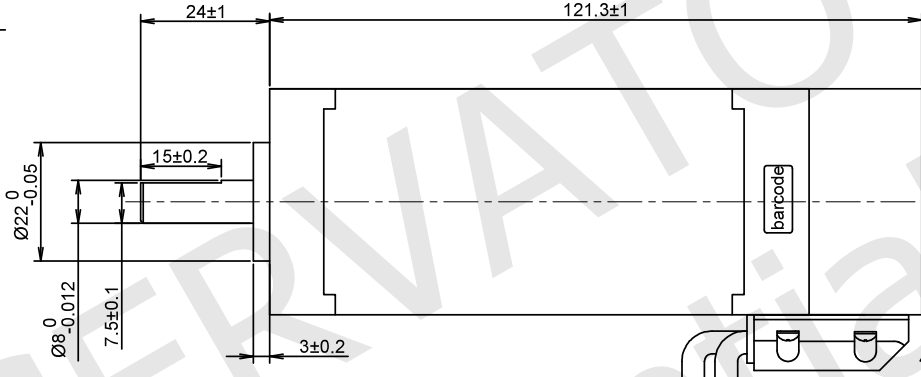
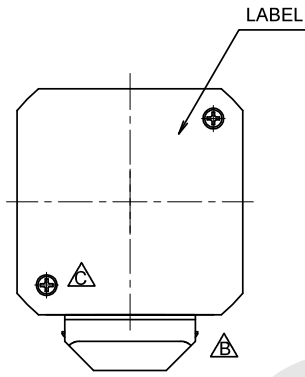
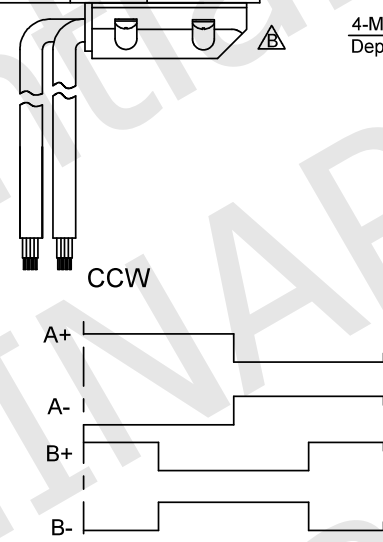
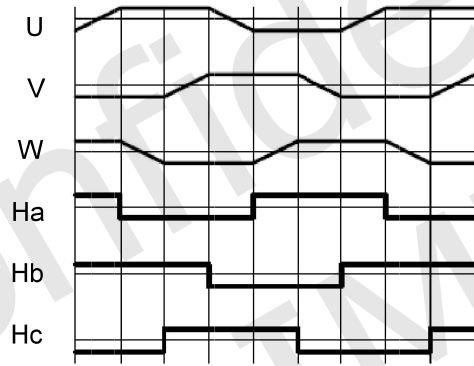

AWG26 Encoder
AWG18 Motor

ENCODER SPECIFICATIONS

ENCODER TYPE	Incremental quadrature
POWER SUPPLY	5.00 Vdc
RESOLUTION	1000 ppr
OUTPUT TYPE	Line Driver

MOTOR SPECIFICATIONS

RATED VOLTAGE	24 Vdc
PHASES	3
POLES	8
RATED CURRENT	8.0 A
PEAK CURRENT	24.0 A
RATED POWER	130 W
RATED TORQUE	0.25 Nm
PEAK TORQUE	0.75 Nm
RATED SPEED	5000 rpm ±10%
NO LOAD SPEED	7400 rpm ±10%
INSULATION CLASS	Class B, 130°C
IP CODE	IP40
LINE TO LINE RESISTANCE	0.25 ohm ±10% at 20°C
LINE TO LINE INDUCTANCE	0.38 mH ±20% at 1kHz
ROTOR INERTIA	96 g.cm ²
BACK EMF CONSTANT	2.28 V/krpm ±10%
OPERATING TEMPERATURE	-20°C ~ +55°C
WEIGHT	800 g. approx
MAX SHAFT AXIAL LOAD	10N
MAX SHAFT RADIAL LOAD	28N

WIRING DIAGRAM

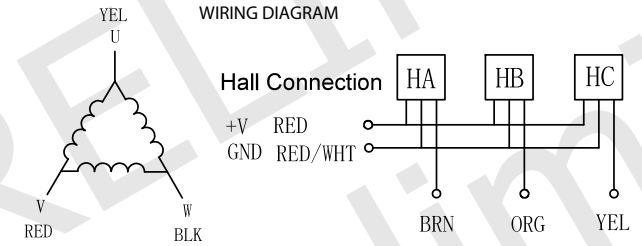

HALL AND ENCODER SIGNAL	COLOUR
SIGNAL	COLOUR
GND	RED/WHT
VCC+	RED
EA-	BLU
EA+	BLU/BLK
EB-	BLK
EB+	BLK/WHT
Ha	BRN
Hb	ORG
Hc	YEL

LABELS

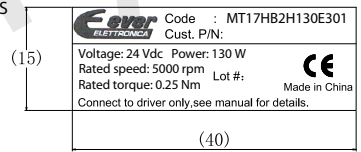

YYWWXXXX (25 x 8)
Stator barcode label

MT17HB2H130E301
DC BRUSHLESS MOTOR SPECIFICATION



UNIT: mm	DESIGN	Stm02363-00c
UNLESS OTHERWISE SPECIFIED TOLERANCES	CHECK	
DIMENSIONS : ±0.3 mm DEGREES : ±5%	APPROVED	
DRAWING NOT TO SCALE	DATE	22 / 12 / 2021
REV	00a - First release.	
	00b - Add the waveform of the encoder.	
	00c - Correct the screws position on rear flange.	